

# Product data sheet

## Miniature connectors



|                     |   |
|---------------------|---|
| Product description | <b>M16 IP67 female cable connector, Contacts: 16, 8.0 - 10.0 mm, shieldable, solder, IP67, UL</b> |
| Area                | <b>M16 IP67 series 423</b>  |
| Order number        | <b>99 5806 15 16</b>  |

### Illustration



### Scale drawing

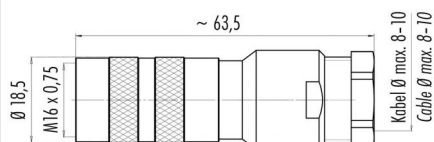

### Contact arrangement (Plug-in side)

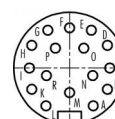

|   | X     | Y     |
|---|-------|-------|
| A | 2,50  | -4,00 |
| B | 4,00  | -2,25 |
| C | 4,25  | 0,00  |
| D | 4,00  | 2,40  |
| E | 2,30  | 4,00  |
| F | 0,00  | 4,25  |
| G | -2,30 | 4,00  |
| H | -4,00 | 2,40  |
| I | -4,25 | 0,00  |
| K | -4,00 | -2,25 |
| L | -2,50 | -4,00 |
| M | 0,00  | -2,60 |
| N | 2,45  | -0,80 |
| O | 1,50  | 2,10  |
| P | -1,50 | 2,10  |
| R | -2,40 | -0,80 |

You can find the component part drawing and assembly instructions on the next page.

## Technical data

### General values

|                          |                           |
|--------------------------|---------------------------|
| Connector design         | female cable connector    |
| Connector locking system | screw                     |
| Termination              | solder                    |
| Wire gauge (mm)          | max. 0.25 mm <sup>2</sup> |
| Wire gauge (AWG)         | max. 24                   |
| Cable outlet             | 8.0 - 10.0 mm             |
| Upper limit temperature  | 95 °C                     |
| Lower limit temperature  | - 30 °C                   |
| Customs tariff number    | 85369010                  |
| Packaging Unit           | 20                        |

### Cable data

|            |    |
|------------|----|
| Approval 1 | UL |
|------------|----|

### Electrical values

|                           |                      |
|---------------------------|----------------------|
| Rated current (40 °C)     | 3 A                  |
| Rated voltage             | 60 V                 |
| Rated impulse voltage     | 500 V                |
| Pollution degree          | 1                    |
| Overvoltage category      | I                    |
| Insulating material group | III                  |
| Insulation resistance     | ≥ 10 <sup>10</sup> Ω |
| EMC compliance            | shieldable           |
| Degree of protection      | IP67                 |
| Mechanical operation      | > 500 Mating cycles  |

### Material

|                       |                      |
|-----------------------|----------------------|
| Contact material      | CuSn (bronze)        |
| Contact plating       | Au (gold)            |
| Contact body material | PBT (UL94 V-0)       |
| REACH SVHC            | CAS 7439-92-1 (Lead) |

Product description **M16 IP67 female cable connector, Contacts: 16, 8.0 - 10.0 mm, shieldable, solder, IP67, UL**

Area **M16 IP67 series 423**  
Order number **99 5806 15 16**

## Component part drawing

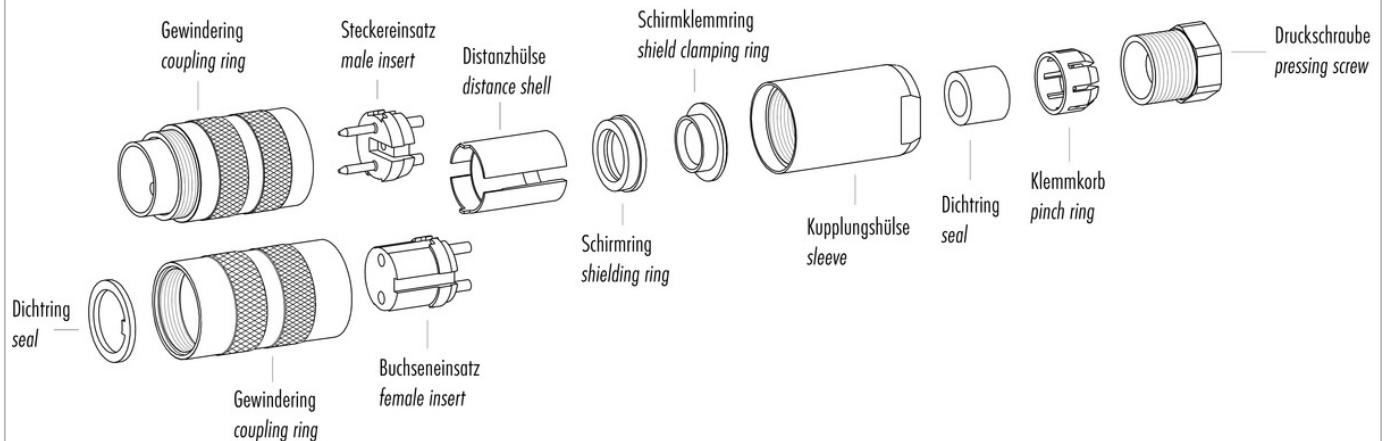

## Assembly instructions / Panel cut-out

### Gerade Version

(Ausführung mit Schirmklemmring)

1. Druckschraube, Klemmkorb, Dichtung, Distanzhülse und ersten Schirmklemmring auffädeln.
2. Litzen abisolieren, Schirm aufweiten und zweiten Schirmklemmring auffädeln.
3. Litzen anlöten, Distanzhülse montieren, die beiden Klemmringe mit dem Schirm zusammenschieben und überstehenden Schirm abschneiden.
4. Übrige Teile gemäß Darstellung montieren.

### Straight version

(Version with shield clamping ring)

1. Bead pressing screw, pinch ring, seal, distance shell and first shield clamping ring on cable.
2. Strip wires, widen shield and bead second shield clamping ring.
3. Solder wires, snap distance shell, push the two shield clamping rings together and cut off projecting shielding braid.
4. Assemble remaining parts according to picture.

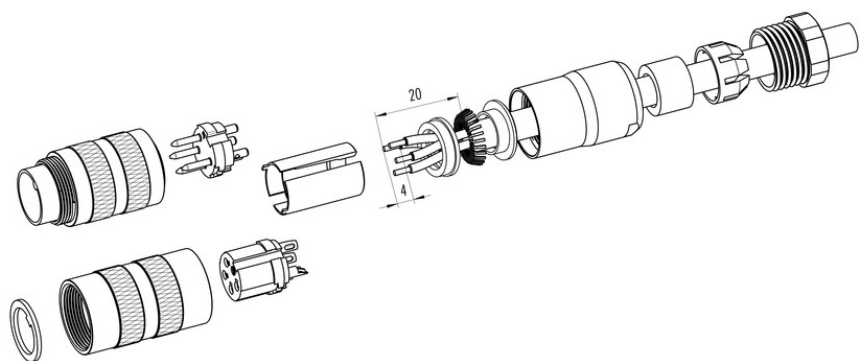

|                     |   |
|---------------------|---|
| Product description | <b>M16 IP67 female cable connector, Contacts: 16, 8.0 - 10.0 mm, shieldable, solder, IP67, UL</b> |
| Area                | <b>M16 IP67 series 423</b>  |
| Order number        | <b>99 5806 15 16</b>  |

## Security notices

The connectors are designed for use in plant, control system and electrical equipment. The end user is responsible for checking whether the connectors are suitable for use in other applications.

Connectors with degree of protection IP 67 and IP 68 are not suitable for use under water. When used outdoors, the connectors must be separately protected against corrosion. For further information about IP degrees of protection refer to 'Technical support' in the Download Centre.

To lock the cable connector to the equipment connector, the threaded ring is tightened until it is 'finger-tight' (approx. 50 cNm).